

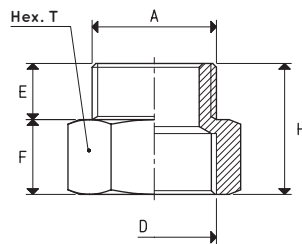

GAS - NPT ADAPTERS

These adapters allow using NPT threaded fittings on vacuum components with NPT threading, such as vacuum components like vacuum cup supports, valves and solenoid valves, filters etc. with gas threading.



FEMALE GAS - MALE NPT ADAPTER

Item	A Ø	D Ø	E	F	H	T	Adapter material	Weight g
00 08 259	1/8" NPT	G1/8"	10	12	22	14	brass	14
00 08 260	1/4" NPT	G1/4"	12	17	29	19	brass	34
00 08 261	3/8" NPT	G3/8"	16	18	34	22	brass	48
00 08 262	1/2" NPT	G1/2"	17	19	36	27	brass	72
00 08 263	3/4" NPT	G3/4"	19	20	39	32	brass	100
00 08 264	1" NPT	G1"	22	20	42	41	brass	176
00 08 265	1" 1/4 NPT	G1" 1/4	23	23	46	50	brass	274
00 08 266	1" 1/2 NPT	G1" 1/2	23	23	46	60	brass	470
00 08 267	2" NPT	G2"	25	24	49	70	brass	506

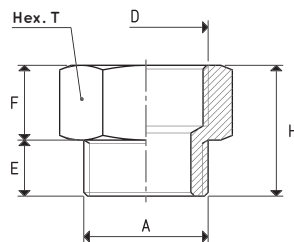

MALE GAS - FEMALE NPT ADAPTER

Item	A Ø	D Ø	E	F	H	T	Adapter material	Weight g
00 08 268	G1/8"	1/8" NPT	10	15	25	14	brass	16
00 08 269	G1/4"	1/4" NPT	11	17	28	19	brass	34
00 08 270	G3/8"	3/8" NPT	12	22	34	22	brass	52
00 08 271	G1/2"	1/2" NPT	14	23	37	27	brass	78
00 08 272	G3/4"	3/4" NPT	14	24	38	32	brass	110
00 08 273	G1"	1" NPT	17	28	45	41	brass	224
00 08 274	G1" 1/4	1" 1/4 NPT	18	28	46	50	brass	290
00 08 275	G1" 1/2	1" 1/2 NPT	19	29	48	60	brass	476
00 08 276	G2"	2" NPT	20	31	51	70	brass	550

Transformation ratio: N (newton) = Kg x 9.81 (force of gravity)

$$\text{inch} = \frac{\text{mm}}{25.4}; \text{pounds} = \frac{\text{g}}{453.6} = \frac{\text{Kg}}{0.4536}$$