

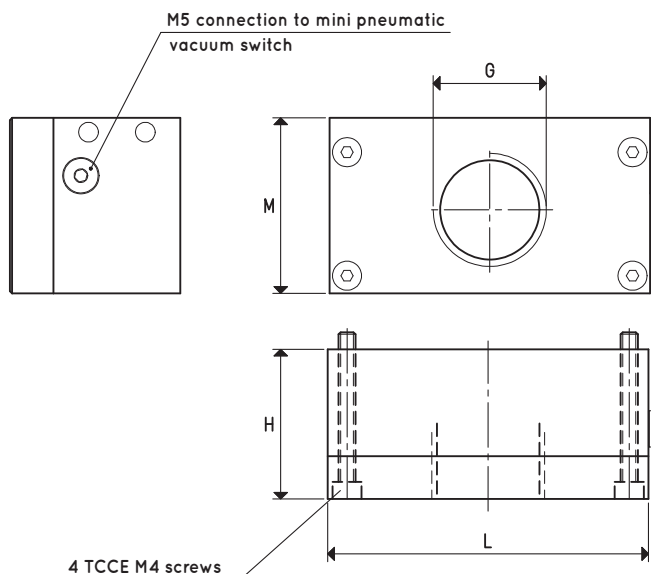

③ - MEMBRANE CHECK VALVE

A check valve specially designed to adapt to vacuum generators PVP 25 - 75 MDX / MDXLP.

The originality of this valve, besides its shape, consists in its membrane seal component, which is able to guarantee very low pressure drops, rapid intervention and perfect sealing.



Item	G Ø	H	L	M	Weight g	For generator item
10 04 20	G3/4"	35	75	41	165	PVP 25 ÷ 50 MDX / MDXLP
10 05 20	G1"	48	113	58	458	PVP 60 ÷ 75 MDX / MDXLP

④ - FLEXIBLE HOSE KIT WITH FITTINGS

This flexible hose kit is used to connect the mini vacuum switch to the coaxial shutter supply valve and the membrane check valve. The appropriate quick couplings are already assembled at the ends of the tubes, to be screwed to the valve and vacuum switch connections.

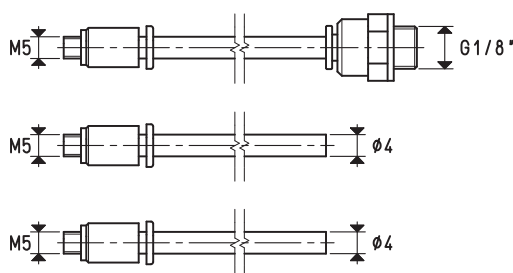

Item	For generator item	Weight g
00 15 308	PVP 25 ÷ 75 MDX / MDXLP	16

COMPLETE KIT FOR ENERGY SAVING DEVICE ES



Item	For generator item	Weight g
ES 01	PVP 25 ÷ 50 MDX / MDXLP	475
ES 02	PVP 60 ÷ 75 MDX / MDXLP	998